

Rectangular photoelectric proximity switches



Features

- Diffuse sensors with operating distance of 300 mm or 800 mm
- Through-beam sensors with operating distance of 15 or 50 m
- Reflex sensors with operating distance of 4 m
- High switching frequency of 1 kHz
- Supply voltage 10...36 VDC, output current 200 mA
- 2 built-in LEDs for output state and excess-gain indication
- Changeover or excess-gain outputs

Benefits

- Top quality designed to cost
- Standard size of 50 x 50 x 18 mm



□ 50x50

Diffuse sensors
300 mm

□ 50x50

Diffuse sensors
800 mm

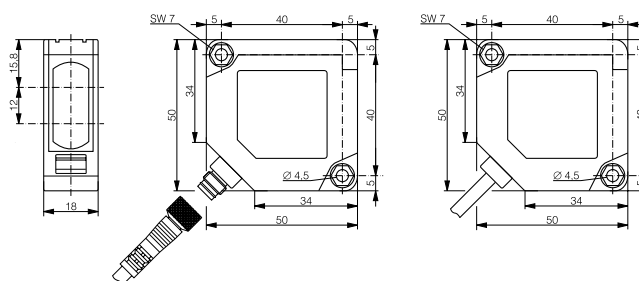

Technical data:

(according to IEC 60947-5-2)

	300 mm	800 mm
Rated operating distance s_n		
Emitter	LED 648 nm (red)	
Modulation frequency	15 kHz	
Supply voltage range U_B	10 ... 36 VDC	
Max. ripple content	20% max.	
Output current (sum)	200 mA max.	
Output voltage drop	2.0 V at 200 mA	
No-load supply current	15 mA max.	
Leakage current	0.1 mA max.	
Switching frequency	1 kHz	
Switching time	0.5 msec max.	
Time delay before availability	50 msec	
Sensitivity setting	Potentiometer	
Ambient temperature range	-5 ... +55 °C (+23 ... + 131 °F)	
Short-circuit protection	Built-in	
Voltage reversal protection	Built-in	
Induction protection	Built-in	
Degree of protection	IP 65	
Housing material	ABS	
Window material	PMMA	
Connection cable	PVC 4 x 0.25 mm ² / 128 x 0.25 mm Ø; 2 m	
Connector	S8 4p	

Types (bold: preferred types)

	Part reference			
	Cable	Connector	Cable	Connector
NPN changeover outputs	LTK-5050-101-501	LTS-5050-101-501	LTK-5050-101	LTS-5050-101
NPN light-ON + excess gain	LTK-5050-102-501	LTS-5050-102-501	LTK-5050-102	LTS-5050-102
PNP changeover outputs	LTK-5050-103-501	LTS-5050-103-501	LTK-5050-103	LTS-5050-103
PNP light-ON + excess gain	LTK-5050-104-501	LTS-5050-104-501	LTK-5050-104	LTS-5050-104
Emitter				

Europe

Austria Belgium Croatia Czech Republic
Denmark Finland France Germany Great Britain
Greece Hungary Ireland Italy Luxembourg
Netherlands Norway Poland Portugal Romania
Slovakia Slovenia Spain Sweden Switzerland
Turkey

Africa

South Africa

The Americas

Argentina Brazil Canada Chile Colombia Mexico
United States Venezuela

Asia

China India Indonesia Japan Korea Malaysia
Pakistan Philippines Singapore Taiwan Thailand
Vietnam

Australasia

Australia New Zealand

Middle East

Egypt Iran Israel Syria



Contrinex

Contrinex has been manufacturing sensors for industrial use since 1972, and today employs over 400 people.

Products

The strength of Contrinex lies in its wide range of highly innovative sensors with special characteristics:

- very small sizes
- very long operating distances
- resistance to extreme environmental conditions (extreme pressure, temperatures etc.)
- all-metal housings

Quality

The high quality of Contrinex products is guaranteed by a well-organized ISO 9001:2000 certified management system.

Customer service

Thanks to a worldwide presence, Contrinex ensures easy contact between customers and the manufacturer.

Catalog

Please consult our catalog for clear and precise information concerning Contrinex's wide range of products:

- [Inductive, Photoelectric and Ultrasonic Proximity Switches](#)

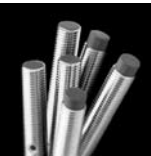

These devices **must not be used** in applications where the **safety of people** is dependent on their functioning. Terms of delivery and rights to change design reserved.

Contrinex Inc.

2 Business Park Road - Old Saybrook, CT 06475 - USA

Tel.: 860 388 3573 - Toll free: 866 289 2899 - Fax: 860 388 3574

Internet: www.contrinex.com - E-mail: info_us@contrinex.com

Your sales agent:





**INDUSTRIAL
SAFETY SALES INC.**

P.O. Box 126 -- 4112 Sheridan Road
Kenosha, WI 53141
Fax: (262) 652-1388
E-mail: safetysensing@earthlink.net

(262) 652-8660